

LOCK NUT CYLINDERS

BETEX JLLC series, single acting, loadreturn

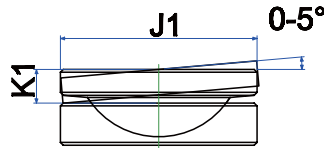
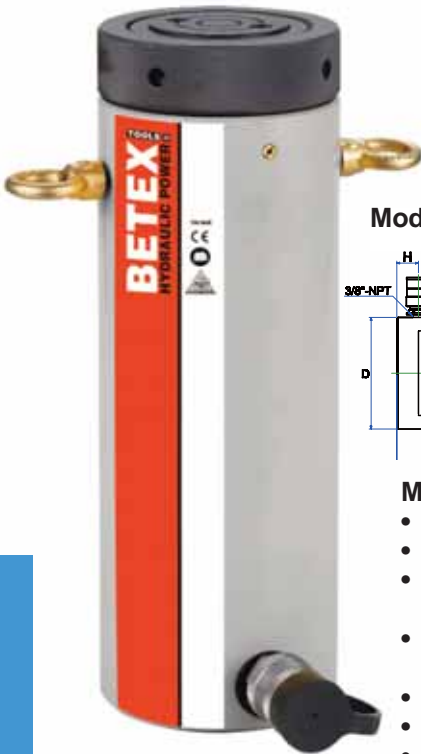

TSA-Optional Tilt Saddle

Model JLLC50-200T

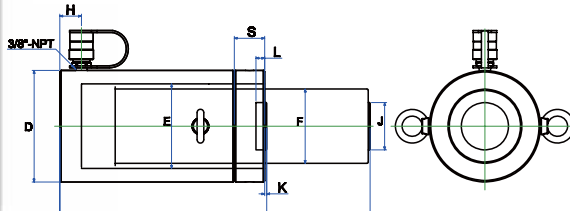

Model JLLC300-1000T

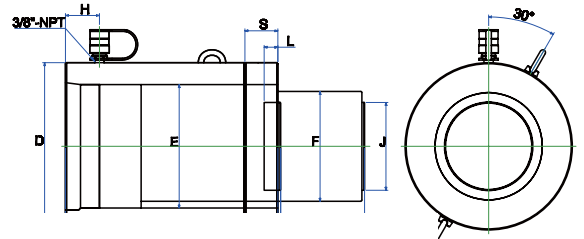

Lock Nut

Capacity : 50-1000 ton
Stroke : 50-300 mm
Max. working pressure : 10,000 psi / 700 bar

Model: JLLC series

- Single-acting, load return
- Safety locknut for mechanical load holding
- Chrome plated to prevent corrosion and to lower friction for smoother operation
- Withstands side-load forces up to 5% of rated cylinder capacity without scoring
- Stop ring for piston blow-out protection
- Interchangeable, hardened, grooved saddle as standard
- High flow coupler and dust cap included on all models

TIP! Use in combination with: hand- and foot pumps, page 42-47. Accessories, page 51-53

JLLC series

| Type | Capacity ton | Stroke mm | Oil cap cm ³ | A Height mm Retr. | B Ext. mm | D ø mm | E ø mm | F mm | H mm | J mm | S mm | Weight Kg | Optional Tilt Saddle | | |
|------------|--------------|-----------|-------------------------|-------------------|-----------|--------|--------|---------|------|------|------|-----------|----------------------|-------|----------|
| | | | | | | | | | | | | | J1 mm | K1 mm | Type |
| JLLC502 | 50 | 50 | 354.5 | 164 | 214 | 125 | 95 | Tr80x4 | 20 | 70 | 35 | 15 | 70 | 24 | TSA-100 |
| JLLC506 | 50 | 150 | 1063.5 | 264 | 414 | 125 | 95 | Tr80x4 | 20 | 70 | 35 | 25 | 70 | 24 | TSA-100 |
| JLLC5010 | 50 | 250 | 1772.5 | 364 | 614 | 125 | 95 | Tr80x4 | 20 | 70 | 35 | 35 | 70 | 24 | TSA-100 |
| JLLC1002 | 100 | 50 | 665 | 187 | 237 | 165 | 130 | Tr110x6 | 32 | 70 | 45 | 30 | 70 | 24 | TSA-100 |
| JLLC1006 | 100 | 150 | 1995 | 287 | 437 | 165 | 130 | Tr110x6 | 32 | 70 | 45 | 48 | 70 | 24 | TSA-100 |
| JLLC10010 | 100 | 250 | 3325 | 387 | 637 | 165 | 130 | Tr110x6 | 32 | 70 | 45 | 64 | 70 | 24 | TSA-100 |
| JLLC1502 | 150 | 50 | 1005 | 209 | 259 | 205 | 160 | Tr140x6 | 49 | 125 | 45 | 53 | 125 | 20 | TSA-200 |
| JLLC1506 | 150 | 150 | 3015 | 309 | 459 | 205 | 160 | Tr140x6 | 49 | 125 | 45 | 78 | 125 | 20 | TSA-200 |
| JLLC15012 | 150 | 300 | 6030 | 459 | 759 | 205 | 160 | Tr140x6 | 49 | 125 | 45 | 117 | 125 | 20 | TSA-200 |
| JLLC2002 | 200 | 50 | 1345 | 243 | 293 | 235 | 185 | Tr170x6 | 52 | 125 | 50 | 83 | 125 | 20 | TSA-200 |
| JLLC2006 | 200 | 150 | 4035 | 343 | 493 | 235 | 185 | Tr170x6 | 52 | 125 | 50 | 117 | 125 | 20 | TSA-200 |
| JLLC20012 | 200 | 300 | 8070 | 493 | 793 | 235 | 185 | Tr170x6 | 52 | 125 | 50 | 170 | 125 | 20 | TSA-200 |
| JLLC3002 | 300 | 50 | 2167.5 | 295 | 345 | 305 | 235 | Tr210x6 | 62 | 155 | 60 | 173 | 195 | 75 | TSA-300 |
| JLLC3006 | 300 | 150 | 6502.5 | 395 | 545 | 305 | 235 | Tr210x6 | 62 | 155 | 60 | 233 | 195 | 75 | TSA-300 |
| JLLC30012 | 300 | 300 | 13005 | 545 | 845 | 305 | 235 | Tr210x6 | 62 | 155 | 60 | 323 | 195 | 75 | TSA-300 |
| JLLC4002 | 400 | 50 | 2755 | 335 | 385 | 355 | 265 | Tr250x6 | 76 | 155 | 70 | 250 | 225 | 85 | TSA-400 |
| JLLC4006 | 400 | 150 | 8265 | 435 | 585 | 355 | 265 | Tr250x6 | 76 | 155 | 70 | 327 | 225 | 85 | TSA-400 |
| JLLC40012 | 400 | 300 | 16530 | 585 | 885 | 355 | 265 | Tr250x6 | 76 | 155 | 70 | 441 | 225 | 85 | TSA-400 |
| JLLC5002 | 500 | 50 | 3532.5 | 375 | 425 | 395 | 300 | Tr280x6 | 81 | 175 | 80 | 367 | 240 | 90 | TSA-500 |
| JLLC5006 | 500 | 150 | 10597.5 | 475 | 625 | 395 | 300 | Tr280x6 | 81 | 175 | 80 | 466 | 240 | 90 | TSA-500 |
| JLLC50012 | 500 | 300 | 21195 | 625 | 925 | 395 | 300 | Tr280x6 | 81 | 175 | 80 | 617 | 240 | 90 | TSA-500 |
| JLLC6002 | 600 | 50 | 4274 | 395 | 445 | 425 | 330 | Tr300x6 | 89 | 195 | 85 | 446 | 275 | 95 | ATS-600 |
| JLLC6006 | 600 | 150 | 12823 | 495 | 645 | 425 | 330 | Tr300x6 | 89 | 195 | 85 | 562 | 275 | 95 | ATS-600 |
| JLLC60012 | 600 | 300 | 25646 | 645 | 945 | 425 | 330 | Tr300x6 | 89 | 195 | 85 | 737 | 275 | 95 | ATS-600 |
| JLLC8002 | 800 | 50 | 5970 | 455 | 505 | 505 | 390 | Tr360x6 | 105 | 225 | 100 | 709 | 315 | 120 | ATS-800 |
| JLLC8006 | 800 | 150 | 17910 | 555 | 705 | 505 | 390 | Tr360x6 | 105 | 225 | 100 | 870 | 315 | 120 | ATS-800 |
| JLLC80012 | 800 | 300 | 35820 | 705 | 1005 | 505 | 390 | Tr360x6 | 105 | 225 | 100 | 1110 | 315 | 120 | ATS-800 |
| JLLC10002 | 1000 | 50 | 7257 | 495 | 545 | 555 | 430 | Tr400x6 | 108 | 245 | 110 | 949 | 355 | 135 | ATS-1000 |
| JLLC10006 | 1000 | 150 | 21772 | 595 | 745 | 555 | 430 | Tr400x6 | 108 | 245 | 110 | 1141 | 355 | 135 | ATS-1000 |
| JLLC100012 | 1000 | 300 | 43544 | 745 | 1045 | 555 | 430 | Tr400x6 | 108 | 245 | 110 | 1430 | 355 | 135 | ATS-1000 |

