

## The origin of Mitutoyo's trustworthy brand of small tool instruments

- Measuring faces: Carbide (**115-101**: only the spindle is carbide tipped.)
- 395 series: IP65 digital spherical-flat anvil type micrometer.
- Equipped with Ratchet Stop for constant measuring force.



Metric				
Order No.	Range	Resolution	Accuracy*	øD
Digimatic (LCD)				
395-251	0 - 25mm	0.001mm	±2µm	ø15
395-252	25 - 50mm			±3µm
395-253	50 - 75mm		ø19	
395-254	75 - 100mm		ø20	

Inch/Metric				
Order No.	Range	Resolution	Accuracy*	øD
Digimatic (LCD)				
395-351	0 - 1"	.00005"/ 0.001mm	±.0001"	ø.59"
395-352	1" - 2"			
395-353	2" - 3"		±.00015"	ø.75"
395-354	3" - 4"			

Metric				
Order No.	Range	Graduation	Accuracy	øD
Analog				
<b>115-101</b>	0 - 15mm	0.01mm	±3µm	ø5.5
<b>115-115</b>	0 - 25mm			ø10
<b>115-116</b>	25 - 50mm			ø11
<b>115-117</b>	50 - 75mm			ø17
<b>115-118</b>	75 - 100mm			ø18
			±4µm	
Mechanical counter model				
<b>295-115</b>	0 - 25mm		±3µm	ø10

Unit: mm

**115-101**

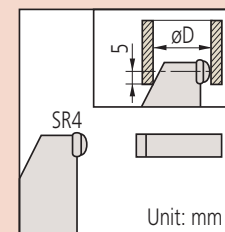

**SR44** (1 pc), **938882**, for initial operational checks  
(standard accessory)

Refer to page A-21 for details.

## IP Codes (395 series)

Level 6: Dust-proof.

No ingress of dust allowed.

Level 5: Protected against water jets.

Water projected in jets against the enclosure from any direction shall have no harmful effects.

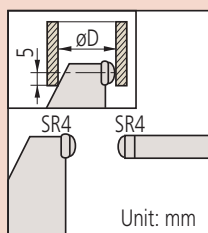

## Battery for series 395

**SR44** (1 pc), **938882**, for initial operational checks (standard accessory)

## Optional accessories

### Connecting cables for 395 series

1m: 05CZA662

2m: 05CZA663

## USB Input Tool Direct

USB-ITN-B (2m): **06ADV380B**

Connecting cables for **U-WAVE-T**

**02AZD790B** 160mm

For foot switch: **02AZE140B**

Refer to page A-21 for details.

## Tube Micrometers

### SERIES 395, 115, 295 — Spherical Anvil and Spindle Type

- Measuring faces: Carbide (**115-201**: only the spindle is carbide tipped.)
- 395 series: IP65 spherical anvil and spindle type digital micrometer.
- Equipped with Ratchet Stop for constant measuring force.



## SPECIFICATIONS

Metric				
Order No.	Range	Resolution	Accuracy*	øD
Digimatic (LCD)				
395-271	0 - 25mm	0.001mm	±2µm	ø15
395-272	25 - 50mm			ø19
395-273	50 - 75mm		±3µm	
395-274	75 - 100mm			

\* Excluding quantizing error

Metric				
Order No.	Range	Graduation	Accuracy	øD
Analog				
115-201	0 - 15mm	0.01mm	±3µm	ø5.5
115-215	0 - 25mm			ø10
115-216	25 - 50mm			ø11
115-217	50 - 75mm			ø17
115-218	75 - 100mm		±4µm	ø18
Mechanical counter model				
295-215	0 - 25mm	0.01mm	±3µm	ø10

Inch/Metric				
Order No.	Range	Resolution	Accuracy*	øD
Digimatic (LCD)				
395-371	0 - 1"	.00005"/ 0.001mm	±.0001"	ø.59"
395-372	1" - 2"			ø.75"
395-373	2" - 3"		±.00015"	ø.79"
395-374	3" - 4"			

\* Excluding quantizing error

Inch	Order No.	Range	Graduation	Accuracy	øD
Analog					
	115-253	0 - 1"	.0001"	±.00015"	ø.40"
	115-242	1 - 2"	.001"		ø.44"
	115-243	2 - 3"			ø.67"
Mechanical counter model					
	295-253	0 - 1"	.0001"	±.00015"	ø.40"

## DIMENSIONS

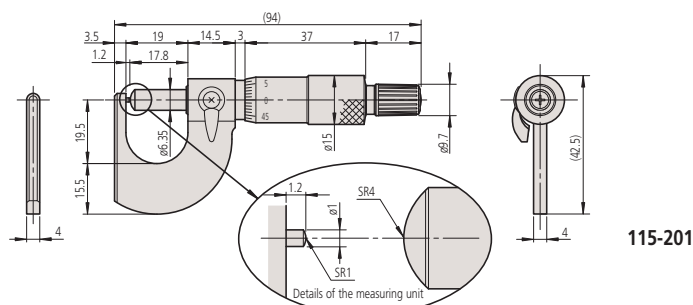

## The origin of Mitutoyo's trustworthy brand of small tool instruments

## SERIES 395, 115, 295 — Spherical and Cylindrical Anvil Type

- Spindle face: Carbide
- 395 Series: IP65 spherical and cylindrical anvil type digital micrometers
- Equipped with Ratchet Stop for constant measuring force.



Metric				
Order No.	Range	Resolution	Accuracy*	Remarks
Digimatic (LCD)				
395-261	0 - 25mm	0.001mm	±3µm	Type A
395-262				Type B
395-263				Type C
395-264				Type D

\* Excluding quantizing error

Metric				
Order No.	Range	Graduation	Accuracy	Remarks
Analog				
115-302	0 - 25mm	0.01mm	±3µm	Type A
115-308				Type B
115-303	25 - 50mm			Type A
115-309				Type B
115-315	0 - 25mm			Type C
115-316				Type D

Inch/Metric				
Order No.	Range	Resolution	Accuracy*	Remarks
Digimatic (LCD)				
395-362	0 - 1"	.00005"/ 0.001mm	±.00015"	Type B
395-363				Type C
395-364				Type D

\* Excluding quantizing error

Inch	Order No.	Range	Graduation	Accuracy	Remarks
Analogue	115-305	0 - 1"	.001"	±.00015"	Type A
	115-313				Type C
	115-314		.0001"		Type D

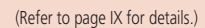
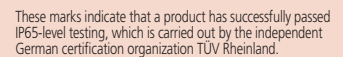

Level 6: Dust-proof.

No ingress of dust allowed.

Level 5: Protected against water jets.

Water projected in jets against the enclosure from any direction shall have no harmful effects.

Type A (pin)



### Type B (spherical)



**Type C** (cylindrical)



**Type D** (cylindrical)

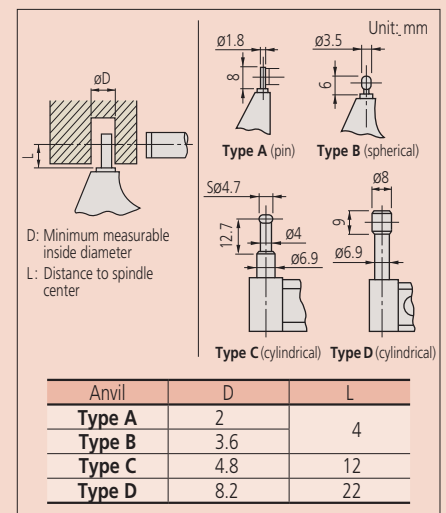
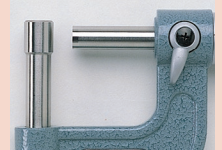

**SR44** (1 pc), **938882**, for initial operational checks  
(standard accessory)

### Connecting cables for 395 series

1m: **05CZA662**

2m: 05CZA663

## USB Input Tool Direct

USB-ITN-B (2m): 06ADV380B

### Connecting cables for **U-WAVE-T**

**02AZD790B** 160mm

For foot switch: **02AZE140B**

Refer to page A-21 for details.