

Styli/Extension Rods (interchangeable styli for dial indicators are usable)

- All threaded portions are M2.5x0.45 x 5mm.
- When exchanging a stylus, firmly tighten the screw so it will not loosen during use. (Recommended tightening torque: 5N·cm)
- Carbide styli are resistant to abrasion.

Ball point

Standard styli are provided.

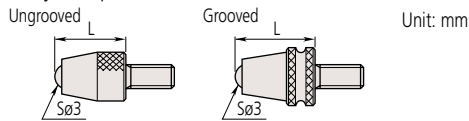

Note: A tip ball of $\phi 0.5$ to 10 is available by special order.

| L | Ball material | Carbide | | Ruby | Nylon |
|------|---------------|-----------|----------------------|-----------|-----------|
| | | Ungrooved | Grooved (Waterproof) | Ungrooved | Ungrooved |
| 7.3 | Order No. | 901312 | — | 120047 | 901994 |
| 8.3 | Order No. | — | 902119 | — | — |
| 12.1 | Order No. | — | 21AA320 | — | — |
| 14 | Order No. | 21AA225 | — | — | — |
| 15 | Order No. | 120049 | — | 120051 | — |
| 17 | Order No. | 21AA224 | — | — | — |
| 19.3 | Order No. | — | 21AA321 | — | — |
| 20 | Order No. | 137391 | — | 137392 | — |
| 22 | Order No. | 21AA226 | — | — | — |
| 25 | Order No. | 120053 | — | 120055 | — |
| 30 | Order No. | 21AA252 | — | 21AA253 | — |

Note: If a probe using the flat point stylus requires squareness to the stem and parallelism with the reference plane, these must be adjusted including the cartridge head before use. Please consult Mitutoyo for special orders.

Spherical point (Carbide)

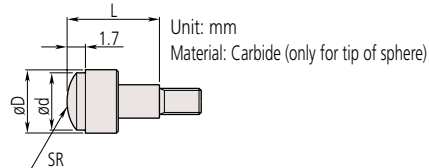

Note: A spherical point with ϕD of up to 40 is available by special order.

| L | D | $\phi 5.2$ ($\phi 4.3 \times 5$) | $\phi 7.5$ ($\phi 6.5 \times 10$) | $\phi 10.5$ ($\phi 9.5 \times 10$) |
|----|-----------|---------------------------------------|--|---|
| | | SR | SR | SR |
| 5 | Order No. | 120058 | — | — |
| 10 | Order No. | — | 120059 | 120060 |

Shell type point

Provided with a large spherical point. This stylus is convenient for plane measurement.

Note: A shell type point with ϕD of 0.5 to 40, SR of 0.2 or more and L of up to 100 is available by special order.

| ϕD | SR | L | Order No. |
|----------|-----|----|-----------|
| 5 | 2.5 | 5 | 101386 |
| | | 10 | 101118 |
| | | 12 | 137393 |
| | | 20 | 101387 |
| | | 25 | 101388 |
| | | 30 | 21AA254 |

Unit: mm
Material: Hardened steel

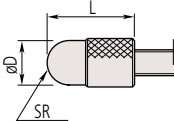

Ball point

Convenient for measuring an indentation.

| ϕD | ϕd | Order No. |
|----------|----------|-----------|
| 1 | 5 | 21AA349 |
| 1.5 | | 21AA350 |
| 1.8 | | 101122 |
| 2.5 | | 21AA351 |
| 4 | | 21AA352 |

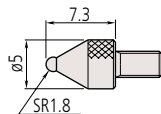

Unit: mm
Material: Hardened steel

No. 101122

* A tip ball of $\phi 0.5$ to 10 is available by special order.

Flat point

Convenient for measuring a workpiece with a spherical measuring surface.

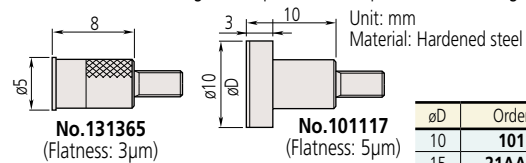

No. 131365
(Flatness: 3μm)

| L | Order No. |
|----|-----------|
| 8 | 13165 |
| 10 | 21AA340 |

No. 101117
(Flatness: 5μm)

| ϕD | Order No. |
|----------|-----------|
| 10 | 101117 |
| 15 | 21AA341 |
| 20 | 21AA342 |
| 25 | 21AA343 |
| 30 | 21AA344 |

Note: A flat point diameter (ϕD) of up to 50 is available by special order.

Note: If a probe using the flat point stylus requires squareness to the stem and parallelism with the reference plane, these must be adjusted including the cartridge head before use. Please consult Mitutoyo for special orders.

Flat point (Carbide)

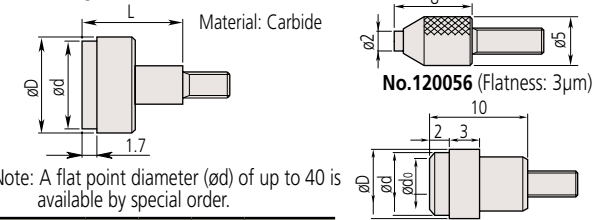

No. 120056 (Flatness: 3μm)

Note: A flat point diameter (ϕD) of up to 40 is available by special order.

| Order No. | d | D | L | Flatness(μm) |
|-----------|-----|------|----|--------------|
| 120041 | 4.3 | 5.2 | 5 | 3 |
| 120042 | 6.5 | 7 | — | |
| 120043 | 9.5 | 10.5 | — | |
| 21AA345 | 15 | 17 | 10 | 5 |
| 21AA346 | 20 | 22 | — | |
| 21AA347 | 25 | 27 | — | |
| 21AA348 | 30 | 32 | — | |

| ϕD | $\phi 3$ | $\phi 4.5$ |
|-----------|------------|------------|
| d | $\phi 6.4$ | $\phi 8$ |
| D | $\phi 7$ | $\phi 9$ |
| Order No. | 137255 | 137399 |

(Flatness: 3μm)

Note: If a probe using the flat point stylus requires squareness to the stem and parallelism with the reference plane, these must be adjusted including the cartridge head before use. Please consult Mitutoyo for special orders.

Needle point

Convenient for measuring the bottom face of a groove or hole.

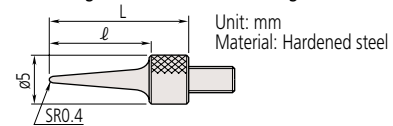

Note: A needle point with SR of 0.2 and L of up to 20 is available by special order.

| Order No. | L | L |
|-----------|-----|-----|
| 101121 | 11 | 15 |
| 137413 | 13 | 17 |
| 21AA255 | 21 | 25 |
| 21AA256 | 31 | 35 |

Needle point (Carbide)

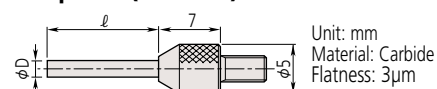

| D | 3 | 5 | 8 | 10 | 13 | 18 | 20 | 28 | 40 |
|-------------|-----------|--------|---------|---------|---------|--------|---------|---------|---------|
| $\phi 0.45$ | Order No. | 120066 | 21AA329 | — | — | — | — | — | — |
| $\phi 1$ | Order No. | 120065 | 21AA330 | 21AA331 | 21AA332 | — | 21AA333 | — | 21AA334 |
| $\phi 1.5$ | Order No. | — | 21AA335 | — | 21AA336 | 120064 | 21AA337 | — | 21AA338 |
| $\phi 2$ | Order No. | — | — | 137257 | — | — | 21AA257 | 21AA258 | 21AA339 |

Note: Consult Mitutoyo for the specifications of products shown in the table above.

Note: If a probe using the flat point stylus requires squareness to the stem and parallelism with the reference plane, these must be adjusted including the cartridge head before use. Please consult Mitutoyo for special orders.