



## Quick Turn T-handle Hex Key Wrench

Sizes across flats : 1.5~10.0mm TL-1.5~10.0



- T shaped handle allows quick turning.
- Long bit reaches bolts deep inside of machinery.



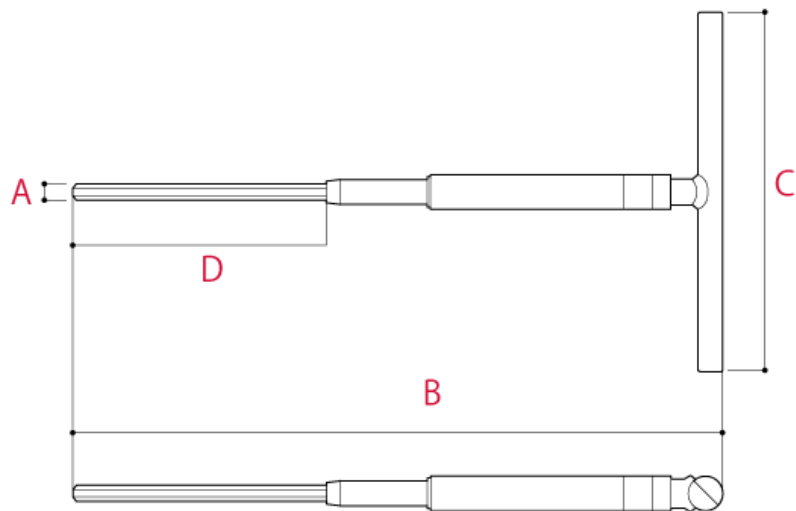

### Specifications

- Material | Alloy steel
- Surface treatment | Solid chrome plating



Part #	A Size across flats (mm)	BxC Vertical length/Handle width (mm)	D Bit length (mm)	Weight(g)	Torque capacity		EAN-code (4952269)
					N · m	kgf · cm	
TL-1.5	1.5	175×60	26	45	0.82	8.36	608595
TL-2.0	2.0	187×70	32	50	1.9	19.4	608588
TL-2.5	2.5	201×80	42	70	3.8	38.7	608571
TL-3.0	3.0	206×90	67	75	6.6	67.3	608564
TL-4.0	4.0	227×105	79	165	16	163	608557
TL-5.0	5.0	248×125	89	230	30	306	608540
TL-6.0	6.0	269×150	103	300	52	530	608533
TL-8.0	8.0	291×175	117	460	120	1224	608526
TL-10.0	10.0	313×200	135	665	220	2243	608519

\*Don't use these items with torque exceeding capacity shown above.

Correspondance between hex key and bolts				
Hex diameter across flats (mm)	Cap screw	Hex socket set screw	Hex socket button head screw	Hex socket countersunk head screw
				
1.5	M1.6 M2	M3		
2.0	M2.5	M4	M3	M3
2.5	M3	M5	M4	M4
3.0	M4	M6 W1/4	M5	M5
4.0	M5	M8 W5/16	M6	M6
5.0	M6 W1/4	M10 W3/8	M8	M8
6.0	M8 W5/16	M12 W1/2	M10	M10
8.0	M10 W3/8	M16 W5/8	M12	M12
10.0	M12 W1/2	M20 W3/4	M16	M16