

# DIGITAL INSIDE GROOVE CALIPERS

DATA  
OUTPUT

- Measure diameter of grooves inside bores
- Resolution: 0.01mm/0.0005"
- Buttons: on/off, set, mm/inch, preset (+, -)
- Automatic power off, move the digital unit to turn on power
- Battery CR2032
- Data output
- Made of stainless steel
- Optional accessory: depth stop (code **6143**), data output cable (code **7315-**, **7302-**, **7305-** for calipers without built-in wireless)

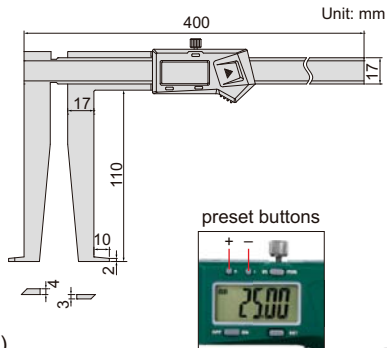

1178-300

depth stop **6143**  
(optional)



sizes to be measured

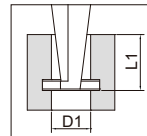

		(mm)	
Code	Range	Accuracy	Wireless
1178-300	25-300mm/1.18-12"	±0.05mm	no
1178-300WL			built-in wireless
D1	L1	Ø25	<50
		Ø26	<60
		Ø27~300	<110